

# AERODROME CHART - ICAO

ARP 514109S 0574639W

AD ELEV 74FT

# STANLEY SFAL

AEROINFO DATE JULY 2019

GUND (Geoid Undulation) =  
The height of the Geoid (MSL) above the Reference Ellipsoid (WGS-84) at the stated position

BEARINGS ARE MAGNETIC  
ELEVATIONS AND HEIGHTS ARE IN FEET

ELEVATIONS IN FEET AMSL	481
HEIGHTS IN FEET ABOVE AD	(48)

RUNWAY/TAXIWAY/APRON PHYSICAL CHARACTERISTICS		
APRON/RWY/TWY	SURFACE	BEARING STRENGTH
RWY 09/27	ASPHALT	PCN14/F/C/X/T
RWY 18/36	ASPHALT	PCN17/F/D/X/T
TWY	ASPHALT	-
APRON	ASPHALT	-

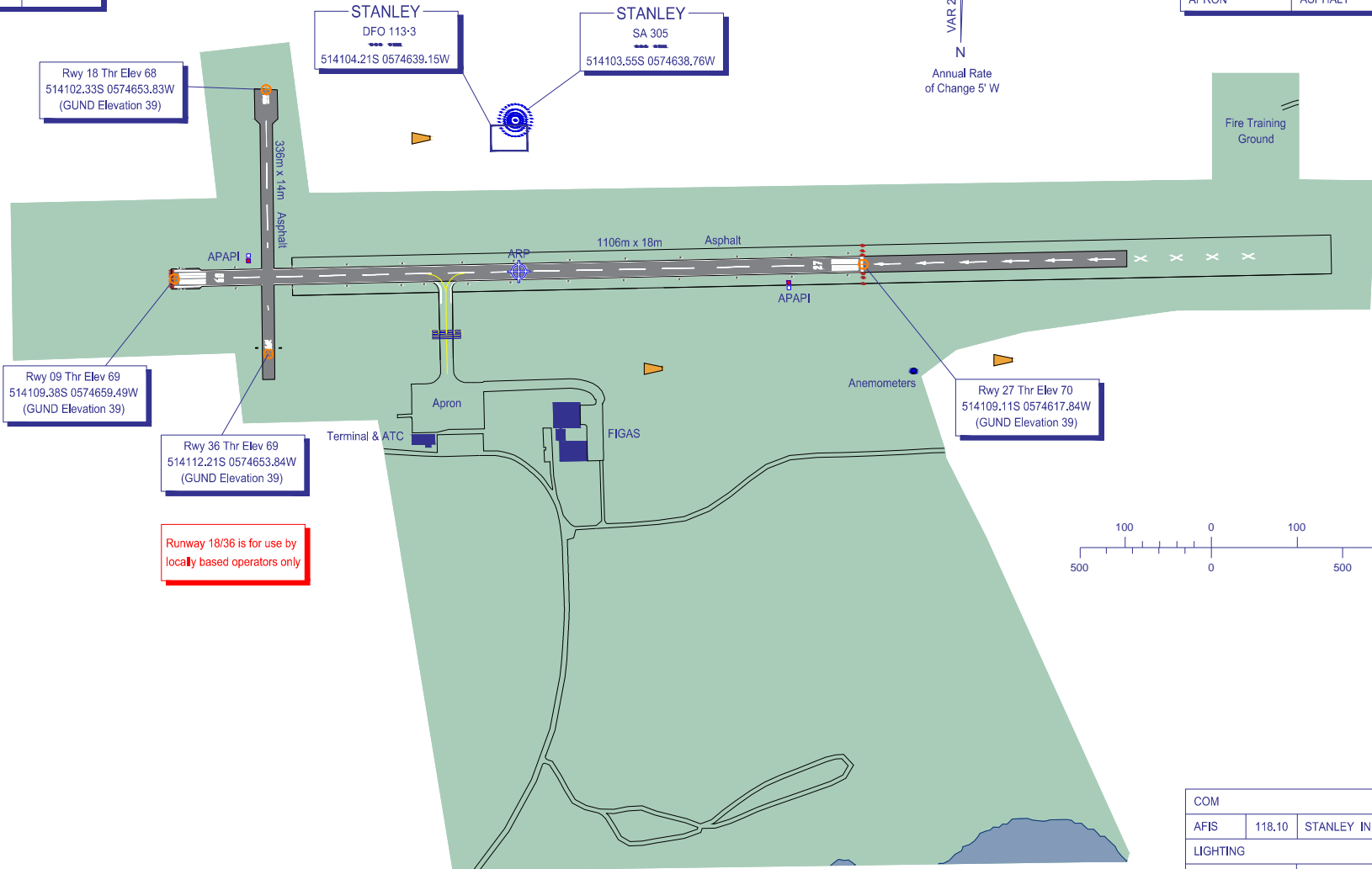

VAR 2.5°E - 2019  
N  
Annual Rate of Change 5' W

Runway 18/36 is for use by locally based operators only

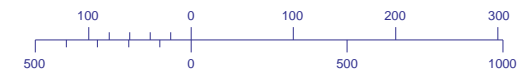

COM		
AFIS	118.10	STANLEY INFORMATION
LIGHTING		
THR 09/27	LI Bi-directional Green	
END 09/27	LI Bi-directional Red	
RWY 09/27	LI Omni-directional White	

CHANGE: WINDSLEEVE MOVED.